

The Gold Domestic Circulator Pump

User & Installation guide

GOLD DOMESTIC CIRCULATOR PUMP



Ενέργεια **Energy** 

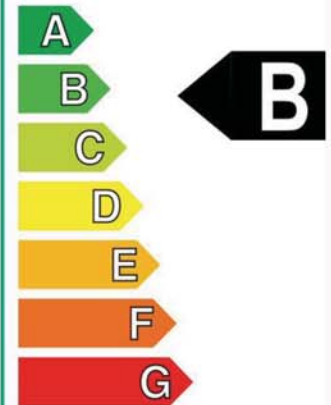

The pumps are of a drum motor design using hard coated shaft and bearings supporting a moulded impeller and rotor. Motor cooling and bearing lubrication is carried out by the pumped water. Models offer a single or variable speed setting to allow system requirements to be accurately met. Electrical connection is through screwless terminals. Models feature a manual restart knob

Operating Range
Maximum static pressure: 10 bar (147p.s.i.) (102m water gauge)
Liquid temperature range: Dew point to +110°C
Protection level: IP44 & IP42
Insulation class: H
Circulating Pumps Limited, PE30 4PP
sales@circulatingpumps.net
www.circulatingpumps.net



Model	Voltage	Pumpcase Configuration	Electrical Data				Capacitor	
			Speed Setting	Speed RPM	Watts Input	Amps	uF	Vac
CP53	230v – 50Hz	130mm x 1.5"	3	2350	52	0.23	2.0	400
			2	1900	46	0.20		
			1	1350	36	0.16		
CP63	230v – 50Hz		3	2200	62	0.27	2.0	400
			2	1800	58	0.25		
			1	1300	38	0.16		

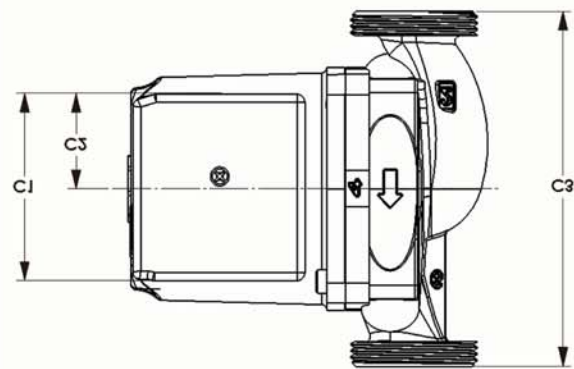
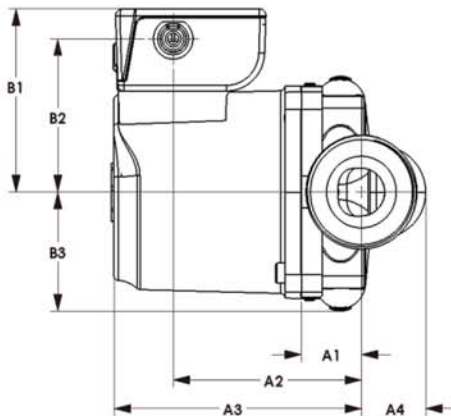

Model	A1	A2	A3	A4	B1	B2	B3	C1	C2	C3	Weight	Pallet
	Dimensions (mm)										Kg	Qty
130 x 1.5"	19.8	74.7	101.5	33.7	76.7	64.1	51.3	68.2	34.1	130	2.7	100 or 240

GOLD DOMESTIC CIRCULATOR PUMP



Performance Curves Water Temperature 20°C

